



# MARATHON STAINLESS STEEL - MAINTENANCE-FREE

Stainless steel and maintenance-free chains



High performance polymer bearing TRIGLEIT

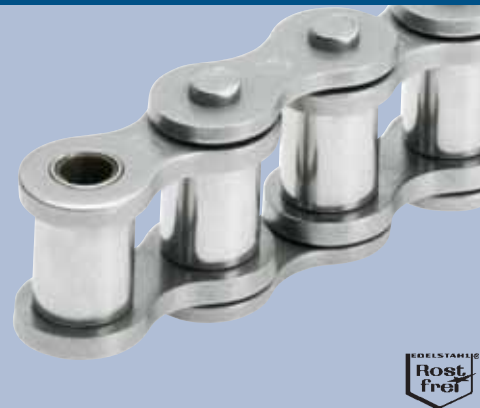

High performance polymer bearing TRIGLEIT Z

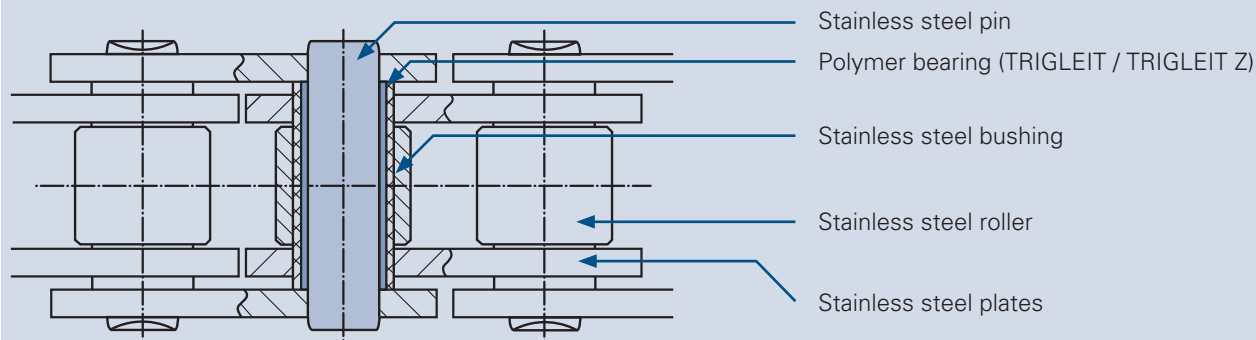

## High performance polymer bearings allow operation of stainless steel chains without relubrication!

- durable and low-friction polymer bearing
- all other chain components made of stainless steel grades
- maximum chain speed  $v = 2,5 \text{ m/s}$
- working temperature  $-30^\circ\text{C}$  to  $+60^\circ\text{C}$  (TRIGLEIT)
- working temperature  $-100^\circ\text{C}$  to  $+200^\circ\text{C}$  (TRIGLEIT Z / TRIGLEIT FDA)
- chain dimensions according to DIN 8187; standard stainless steel sprockets can be used
- no relubrication required
- relubrication with mineral oils possible (no ester oils)
- can also be supplied with extended pins, straight attachments, bent attachments and in special designs
- information on chemical resistance on request
- durable water resistance (TRIGLEIT Z / TRIGLEIT FDA)

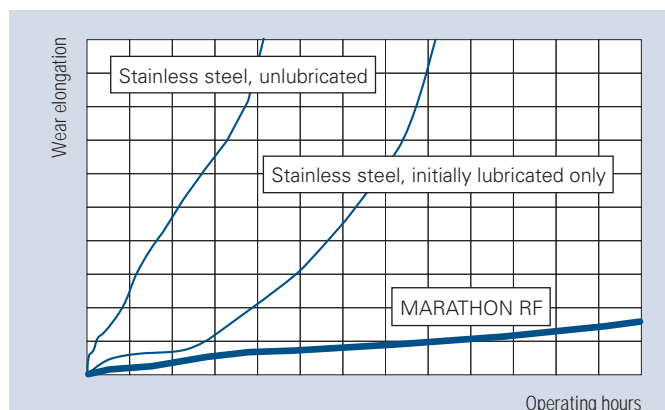

Results of long-term wear tests

### Application areas:

- Packing industry
- Chemical industry
- Pharmaceutical industry
- Textile industry
- Food industry
- Sanitation industry
- Electrical industry



### Simplex chains

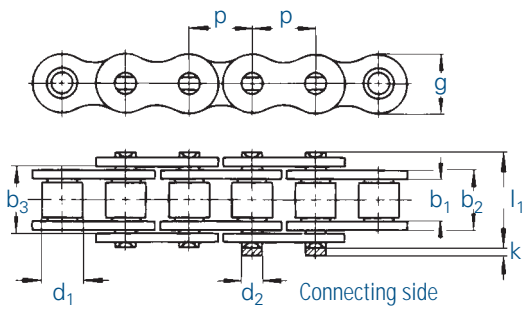

### Simplex chains (Type GL)

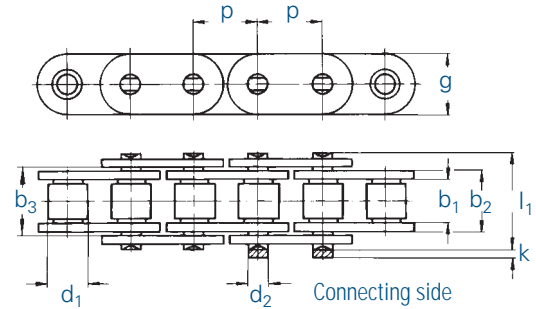

### Duplex chains

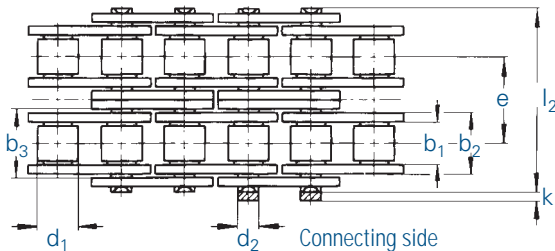

### Triplex chains

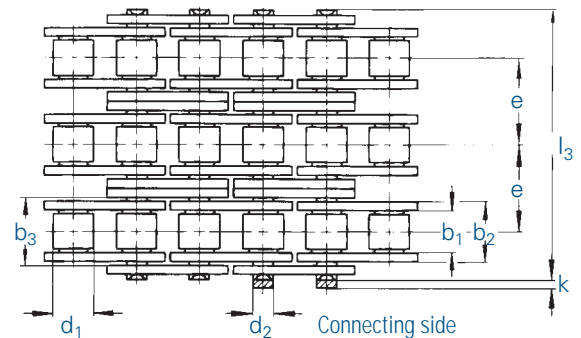

Chain		DIN	Pitch		Inner width	Inner link width	Outer plate width	Roller Ø	Pin Ø	Transverse pitch	Plate height	Projection over connecting link	Width over pin	Bearing area	Minimum tensile strength	Weight	Connecting links
Nr.	Ind.		p		b <sub>1</sub> min.	b <sub>2</sub> max.	b <sub>3</sub> min.	d <sub>1</sub> max.	d <sub>2</sub> max.	e	g max.	k max.	l max.	f	F <sub>B</sub> min.	q ≈	Nr.
462 RF MA		08 B-1	12,7	1/2	7,75	11,30	11,43	8,51	4,45	-	11,8	3,9	17,0	0,50	12,00	0,70	4,7,11,12,15
501 RF MA		10 B-1	15,875	5/8	9,65	13,28	13,41	10,16	5,08	-	14,7	4,1	19,6	0,67	14,50	0,91	4,7,11,12,15
513 RF MA		12 B-1	19,05	3/4	11,68	15,62	15,75	12,07	5,72	-	16,1	4,6	22,7	0,89	18,50	1,18	4,7,11,12,15
548 RF MA		16 B-1	25,4	1	17,02	25,40	25,60	15,88	8,28	-	21,0	5,4	36,1	2,10	40,00	2,50	4,7,11,12
D 462 RF MA		08 B-2	12,7	1/2	7,75	11,30	11,43	8,51	4,45	13,92	11,8	3,9	31,0	1,01	20,40	1,36	4,7,11,12,15
D 501 RF MA		10 B-2	15,875	5/8	9,65	13,28	13,41	10,16	5,08	16,59	14,7	4,1	36,2	1,34	24,65	1,82	4,7,11,12,15
D 513 RF MA		12 B-2	19,05	3/4	11,68	15,62	15,75	12,07	5,72	19,46	16,1	4,6	42,2	1,79	31,45	2,38	4,7,11,12,15
D 548 RF MA		16 B-2	25,4	1	17,02	25,40	25,60	15,88	8,28	31,88	21,0	5,4	68,0	4,21	68,00	5,10	4,7,11,12
T 462 RF MA		08 B-3	12,7	1/2	7,75	11,30	11,43	8,51	4,45	13,92	11,8	3,9	44,9	1,51	32,50	2,01	4,7,11,12,15
T 501 RF MA		10 B-3	15,875	5/8	9,65	13,28	13,41	10,16	5,08	16,59	14,7	4,1	52,8	2,02	39,00	2,70	4,7,11,12,15
T 513 RF MA		12 B-3	19,05	3/4	11,68	15,62	15,75	12,07	5,72	19,46	16,1	4,6	61,7	2,68	49,50	3,12	4,7,11,12,15
T 548 RF MA		16 B-3	25,4	1	17,02	25,40	25,60	15,88	8,28	31,88	21,0	5,4	99,9	6,31	108,00	7,50	4,7,11,12

Can also be supplied with attachments, straight plates (type series GL) and as double pitch roller chains (dimensions according to DIN 8181). Chains 548 available as type series GLS with plate height g = 21 mm (max.) and as type series GL with g = 24 mm (max.). Sprockets on request.

### Connecting links: According to DIN (...)



Nr. 4 (B)

Inner link

Nr. 7 (A)

Outer link  
(to be riveted)

Nr. 11 (E)

Spring clip  
connecting link

Nr. 111 (S)

Connecting link  
with cottered pin

Nr. 12 (L)

Single  
cranked link

Nr. 15 (C)

Double  
cranked link